

Parade of Homes Fall ShowcaseSM Entry Form

2009 Parade of HomesSM September 11 - October 4, 2009

All entries must be received by the Builders Association of the Twin Cities (BATC) by
 Wednesday, May 20, 2009, including entry fee. BATC, 2960 Centre Pointe Drive, Roseville, MN 55113

PLEASE TYPE OR PRINT

ENTRY DEADLINE: MAY 20, 2009

A. BUILDER INFORMATION

- Complete Member Company Name: _____
- Contact Person: _____
 Phone: _____ Fax: _____
 Contact Email Address: _____
- Complete** Contact Address: (where proofs and signs will be sent)

 City/State/Zip: _____
- Builder License # (include photocopy): _____ Expires: _____

OFFICE USE ONLY

Code: _____

Check #: _____

Check Amount: _____

No. of Entries: # _____ of _____

Initials: _____

CHECK \$2,995 (includes sign escrow)

BUILDER LICENSE (3/10)

PARTICIPATION AGREEMENT

LIABILITY INSURANCE (10/4)

HUDSON/KING MAP COPY

CLASS D/E FORM

INTERNET INFO. FORM

LIFESTYLE CATEGORIES

ELEVATION: _____ REUSE
 _____ CAMERA READY

B. REPEAT ENTRY

If your entry is a **COMPLETE** repeat (exact address) we only need sections A & B completed on this form:

- City: _____
- Previous Event: Spring Fall EasyStreet Year: _____
- Entry #: _____

C. ENTRY HOME INFORMATION

- Website Address: _____
- Name of Development: _____
- Street Address: _____ City: _____ Zip Code: _____
- Phone Numbers to be listed (include area code): 1) _____ 2) _____
- Exact Model Home Price: \$ _____ Others From: \$ _____
- Type of Home (check one): Single-family Association-Maintained Attached Association-Maintained Detached Condo
- Is this entry: Display Model Sold For-Sale
- No. of Bedrooms: _____
- No. of Bathrooms: _____
- Square Footage: _____
- School District #: _____
- Is this entry: Two-Story Rambler Split-Entry Multi-Level Mod. Two-Story Townhome Twin Home Condo
- Do you have experience building wheelchair accessible homes? Yes No
- Is this entry wheelchair visitable? Yes No
- Is this entry a Minnesota GreenStar Certified home? Yes No

D. DESCRIPTION INFO.

ATTACH YOUR HOME DESCRIPTION

- Or,
 REUSE DESCRIPTION?
 Spring Fall EasyStreet
 Year: _____ Home #: _____

- 550-character limit.** Your copy may be edited as per BATC's editorial style and space limitations.
- Describe the home's features/ neighborhood—not who should live there.
- Do not include names of any other firms (architects, interior designers, etc.) unless they are members of BATC. We recommend you do not include names of real estate agent(s) who represent you due to the long lead-time and shelf-life of the publication.

E. MAP INFORMATION

IF NEW: DRAW A MAP TO HOME.

Include street names and model location with an "X" or dot and include a Hudson/King map copy.

- REUSE MAP?**
 Spring Fall EasyStreet
 Year: _____ Home #: _____

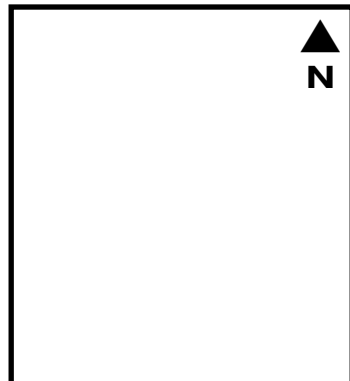

F. WRITTEN DIRECTIONS

GIVE DIRECTIONS TO HOME:

Approximately 140-character limit. Coordinating with your drawn map, follow this style:

Highway 99 to County Road 88; north to ABC Drive; west to XYZ Circle; right to model on the left.

- REUSE DIRECTIONS?**
 Spring Fall EasyStreet
 Year: _____ Home #: _____

G. ILLUSTRATION

- REUSE ART?**
 Spring Fall
 EasyStreet
 Year: _____ Home #: _____

- IF YOU SUBMIT A FRONT ELEVATION** for our artist to work from, mark up any revisions in red. Label materials with company name. If multi-family, indicate which unit.
- If you want to provide your own final art, professional illustrations preferred, but we will accept halftones (grayscale) and CAD. **PHOTOS NOT ALLOWED. DUE 7/2.**
- DIGITAL GUIDELINES:** 300 dots per inch for grayscale or CAD; 1200 dpi for line art; JPEG, TIF or EPS formats; 2.75 in. x 1.75 inch live area.

Mail materials to Linda, BATC,
 2960 Centre Pointe Drive,
 Roseville, MN 55113
 Email files to parade@batc.org